



Lauderdale Road
Maida Vale, W9

£1,150,000

🛏️ 3 🚿 1 🏠 Flat/Apartment

HOMESITE

Wonderfully bright and spacious three bedroom flat

FULL DETAILS

This incredibly spacious three double bedroom apartment is located in this beautiful period mansion building and benefits from a large south facing reception room. The flat is a very generous size at approx. 1460 sq ft / 135 m2 which gives the apartment a very spacious feel. Full of natural light and comprising of a double length reception room, three double bedrooms, large bathroom and family kitchen. Lauderdale Road is an attractive tree lined street well located to give easy access to the amenities of both Maida Vale and Little Venice.

Leasehold approx 981 years remaining. Service charge approx. £8747 pa.

PROPERTY FEATURES

- Three Double Bedrooms
- Full of Natural Light
- Double length reception room
- Approx 1460 sq ft / 135 m2
- Period Mansion Building
- Large Separate Kitchen
- Attractive Tree Lined Street
- Bang G - Westminster Council

PROPERTY INFO

TENURE
Leasehold, approx. 981 years remaining

SERVICE CHARGE
approx. £8,747 pa

Energy Efficiency Rating		Current	Potential
Very energy efficient - lower running costs			
(92-)	A		
(81-91)	B		
(69-80)	C		
(55-68)	D	66	79
(39-54)	E		
(21-38)	F		
(1-20)	G		
Not energy efficient - higher running costs			
England, Scotland & Wales		EU Directive 2002/91/EC	

Lauderdale Mansions, Lauderdale Road, W9

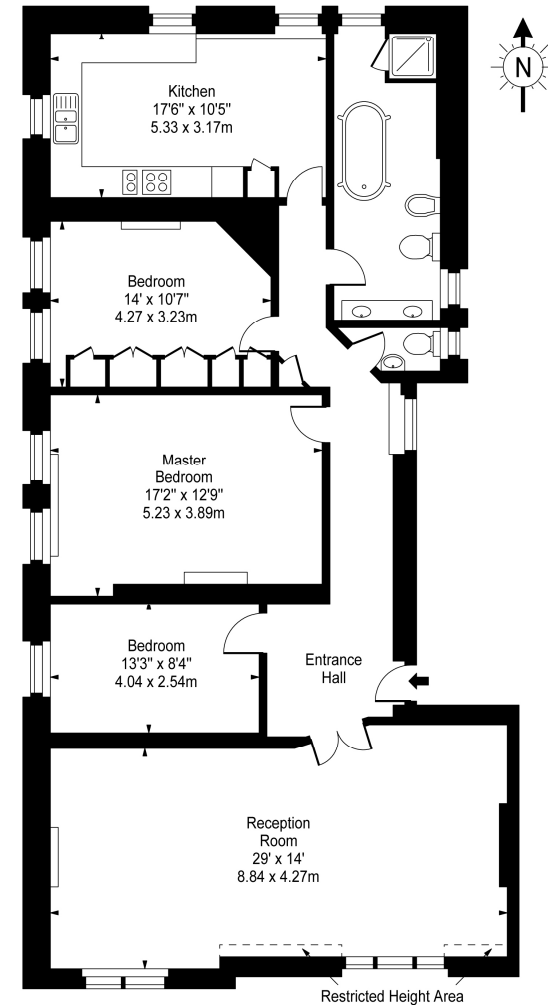

Fourth Floor
Approx Gross Internal Area **1460 Sq Ft - 135.63 Sq M**
(Including Restricted Height Area)
For Illustration Purposes Only - Not To Scale
www.goldlens.co.uk
Ref. No. 00446