



Ladbroke Grove
North Kensington, W10

£429,950

🛏️ 1 🚿 1 🏠 Flat/Apartment

HOMESITE

Bright first floor apartment with high ceilings

FULL DETAILS

A bright first floor apartment with high ceilings and wooden floors located on this popular parade in North Kensington. The property comprises of a reception room, double bedroom, family bathroom and separate kitchen. Situated a short walk from the fantastic array of shops, cafes and restaurants of Portobello Road, Golborne Road and Notting Hill. The property is also surrounded by fantastic transport links including multiple bus routes and Ladbroke Grove tube station (Hammersmith & City and Circle lines).

PROPERTY FEATURES

- First Floor
- High Ceilings
- Reception Room
- Double Bedroom
- Wooden Floors
- Approx. 429 sq ft / 39.86 m²
- Moments from Ladbroke Grove Tube station
- Council Tax Band C – Kensington & Chelsea

PROPERTY INFO

TENURE
Leasehold, approx. 91 years remaining

SERVICE CHARGE
approx. £1300 pa

GROUND RENT
approx. £300 pa

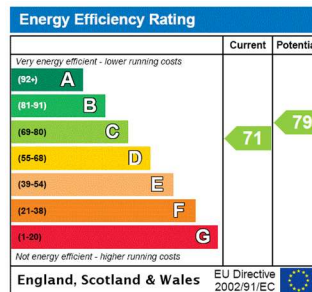

Ladbroke Grove

Approx. Gross Internal Area 429 Sq Ft - 39.86 Sq M

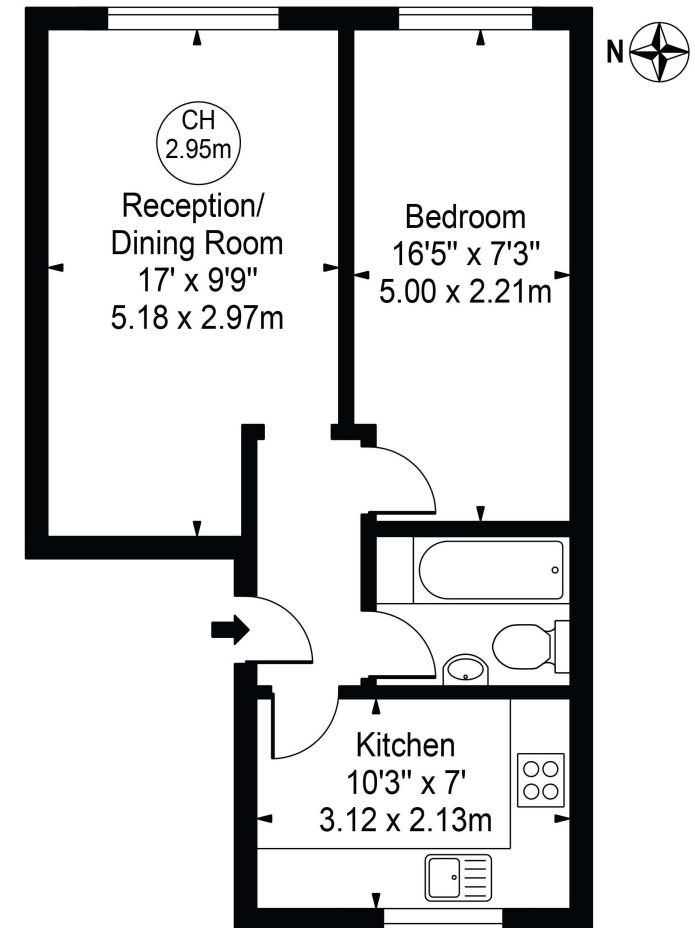

For Illustration Purposes Only - Not To Scale

This floor plan should be used as a general outline for guidance only and does not constitute in whole or in part an offer or contract. Any intending purchaser or lessee should satisfy themselves by inspection, searches, enquiries and full survey as to the correctness of each statement. Any areas, measurements or distances quoted are approximate and should not be used to value a property or be the basis of any sale or let.