



St James's Gardens  
Holland Park, W11

£650,000

🛏️ 1 🚿 1 🏠 Flat/Apartment

HOMESITE

# South facing apartment with wonderful views over communal gardens

ST. JAMES GARDENS, W11

Approx. gross internal area  
450 Sq Ft. / 41.8 Sq M.



## FULL DETAILS

A delightful south facing one bedroom apartment on the top floor of this striking period terrace with lovely views over and access to communal gardens (with fob entry). The property boasts a large double bedroom to the rear of the property, plenty of storage and a bright reception room and separate kitchen. St James's Gardens is one of Holland Parks' most desirable squares surrounding a beautiful communal garden. Holland Park tube station (Central line) is a short walk away as are the vast array of shops, restaurants and cafes of Holland Park Avenue and Notting Hill. Westfield shopping centre is also close by along with the A40 for easy access in and out of London.

## PROPERTY FEATURES

- Access to Communal Gardens (fob entry)
- Large double bedroom at the rear of the property
- South facing reception room
- Separate kitchen
- Good Storage throughout
- Long lease
- Approx. 450 sq. ft / 41.8 m2
- Council Tax Band E - Kensington & Chelsea

## PROPERTY INFO

**TENURE**  
Leasehold, approx. 140 years

**SERVICE CHARGE**  
£500.00

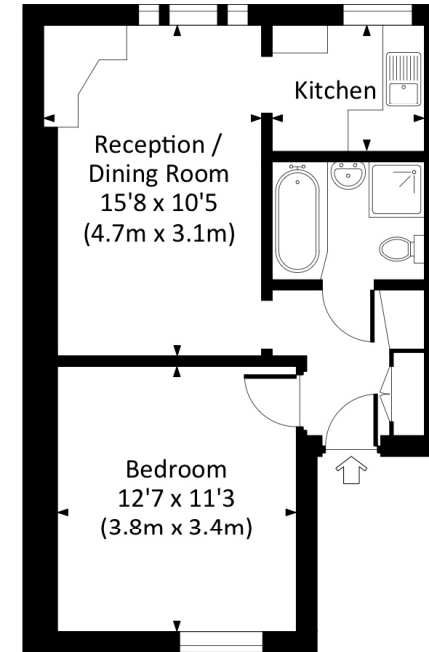
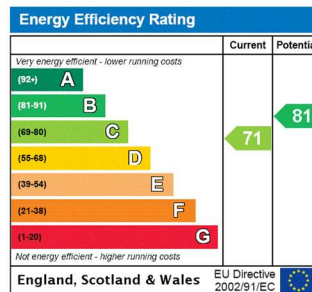

THIRD FLOOR



All measurements have been made in accordance with RICS code of Measuring Practice which are approximate only and only for illustrative purposes. For the avoidance of doubt, Dowling Jones Design shall not be liable for any reliance on these measurements. © 2019 www.dowlingjones.com 020 7610 9933