

Kensington Gardens Squar
Bayswater, W2

£800,000

🛏️ 1 🚿 1 🏠 Flat/Apartment

HOMESITE

Large one bedroom apartment with balcony



FULL DETAILS

This very spacious one double bedroom apartment is bright and has an open plan kitchen and balcony that links the living room and bedroom. It's located on the second floor of this very well run portered building in Bayswater and has use of an on-site gym & swimming pool. The vast array of shops, cafes, bars and restaurants that Bayswater and Notting Hill has to offer are right on your doorstep. Transport links include Bayswater, Queensway and Royal Oak tube stations giving access to the central, circle, district and hammersmith & city lines. Paddington Rail and tube station is also easily accessible along with the Elizabeth Line and Heathrow Express making this a very convenient location to live. The beautiful open spaces of Hyde Park and Kensington Gardens are also a short walk away. Parking space included.

Leasehold approx 967 years remaining. Service Charge approx. £1528 per quarter.

PROPERTY FEATURES

- Lateral Apartment
- Double Bedroom with storage
- Private Balcony
- Large Reception Room
- Open Plan Kitchen
- On site Gymnasium, Swimming Pool & Sauna
- Underground Parking Space
- 24 hour porter
- Council Tax Band G

PROPERTY INFO

TENURE
Leasehold, 965 years remaining

SERVICE CHARGE
£ per annum

GROUND RENT
£ per annum

Energy Efficiency Rating		Current	Potential
Very energy efficient - lower running costs			
(92-)	A		
(81-91)	B		
(69-80)	C		
(55-68)	D		
(39-54)	E		
(21-38)	F		
(1-20)	G		
Not energy efficient - higher running costs			
England, Scotland & Wales		77	79
EU Directive 2002/91/EC			

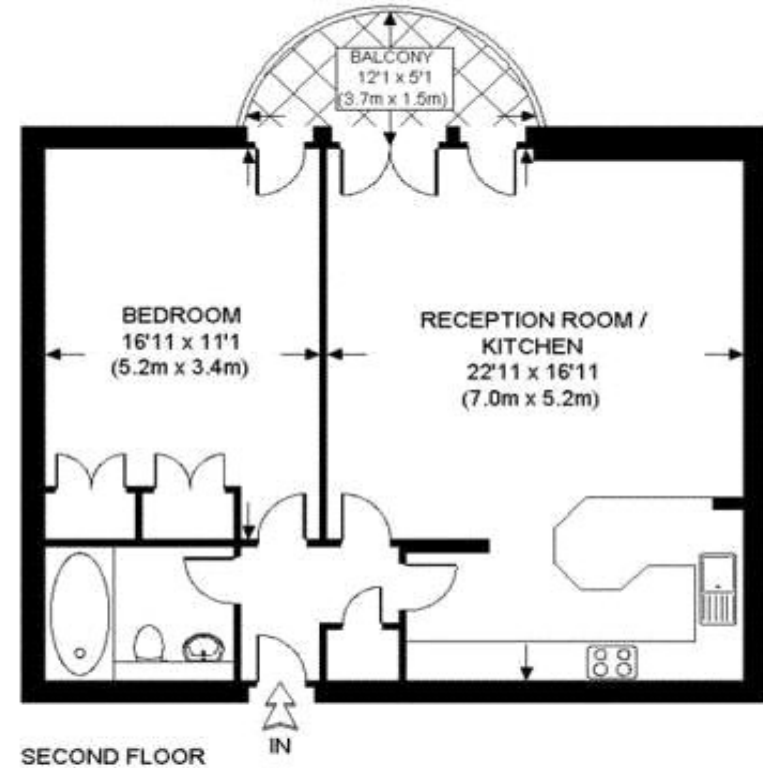

APPROXIMATE GROSS INTERNAL AREA =
TOTAL = 653 SQ. FT. (60.7 SQ. M.)

This plan is for layout guidance only. Not drawn to scale unless stated. Windows & door openings are approximate. Whilst every care is taken in the preparation of this plan, please check all dimensions, shapes & compass bearings before making any decisions reliant upon them.