



Kensington Church Street
Kensington, W8

£525 per week

🛏️ 1 🚿 1 🏠 Flat/Apartment

HOMESITE

Bright one bedroom apartment with wooden floors

FULL DETAILS

A bright and well-presented 1-bedroom apartment set within an elegant period building in the heart of Kensington. This bright and thoughtfully designed home boasts beautiful wooden floors and a charming layout. Ideally located, it provides easy access to High Street Kensington and Notting Hill Gate tube stations, as well as the area's vibrant shops, cafés, and green spaces. A perfect choice for those seeking style and convenience in a prime London location.

PROPERTY FEATURES

- Double Bedroom
- Wooden Floors
- 2nd Floor
- Spacious
- Period Building
- Council Tax Band C - Kensington and Chelsea

Energy Efficiency Rating		Current	Potential
Very energy efficient - lower running costs			
(92+)	A		
(81-91)	B		
(69-80)	C		
(55-68)	D	59	74
(39-54)	E		
(21-38)	F		
(1-20)	G		
Not energy efficient - higher running costs			
England, Scotland & Wales		EU Directive 2002/91/EC	

Kensington, Church Street, W8

Approx. Total Internal Area 306 Sq Ft - 28.43 Sq M
(Including Restricted Height Area)

Approx. Gross Internal Area 281 Sq Ft - 26.11 Sq M
(Excluding Restricted Height Area)

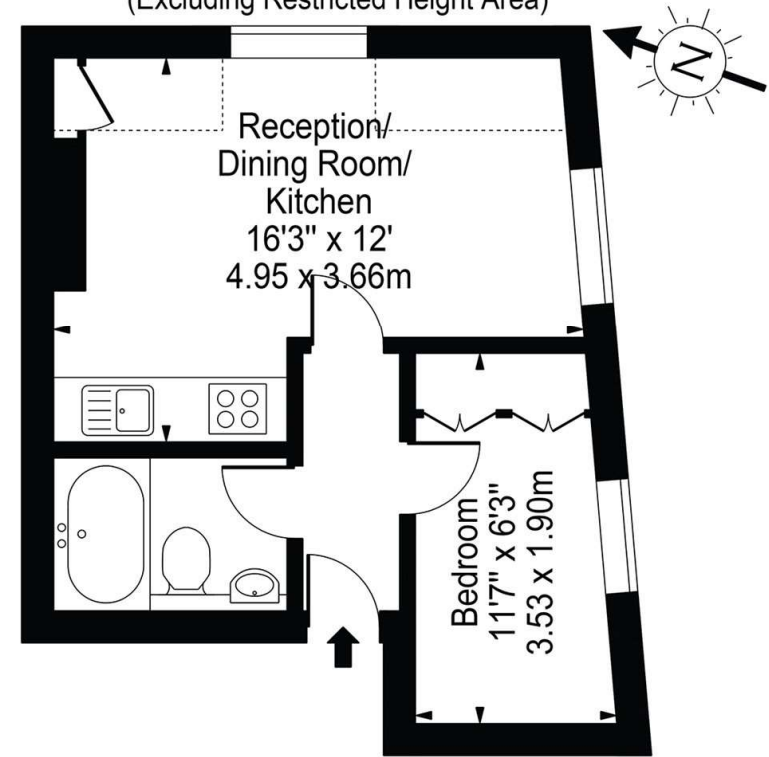

Second Floor

For Illustration Purposes Only - Not To Scale Floor Plan by Mira Nikolova Photography

This floor plan should be used as a general outline for guidance only and does not constitute in whole or in part an offer or contract. Any intending purchaser or lessee should satisfy themselves by inspection, searches, enquiries and full survey as to the correctness of each statement. Any areas, measurements or distances quoted are approximate and should not be used to value a property or be the basis of any sale or let.

*Tenant admin fee: 1 person (£100 + VAT), 2 people (£200 + VAT), 3 people (£250 + VAT), 4 people (£300 + VAT), Referencing: £30 per person, Renewal Agreement fee: £50 (including VAT). Typical deposit equal to 6 weeks rent and rent is paid in advance (normally monthly or quarterly). There will be a check out fee at the end of the tenancy, the price of which will depend on the size of the property. N.B. We have produced these sales particulars as a general guide. It is essential that you check with us before undertaking an inspection. We have not carried out a detailed survey of the property and have not tested the services, appliances or specific fittings. Room sizes are for general guidance purposes and should not be relied upon for fitting carpets or furnishings. Pictures may have been digitally enhanced. Floor plans are not to scale. Fittings shown on floor plans may not match the actual layout or size of fittings at the property. None of the statements as to the property contained in these particulars are to be relied upon as statements or representations of fact. All statements in these particulars as to this property are made without responsibility on the part of Homesite. The vendor does not make or give and neither Homesite nor any person in their employment has the authority to make or give any representation or warranty whatever in relation to this property.